

To Whom It Concerns:

This cover letter is submitted by Louis Structures LLC, (LS) the operator of a now patented recycling process, to request Initial Site Inspection at the former Sheboygan Falls Asylum located at N3773 Garden Parkway in Sheboygan Falls, Wisconsin. Our proposed solid waste processing facility design and operation are summarized in the following diagram.

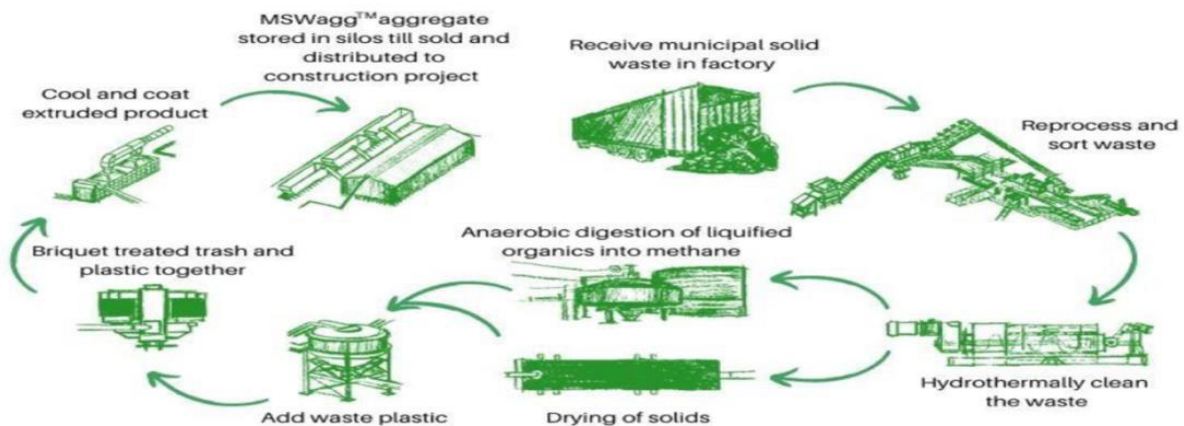

LS owns a patented recycling process that transforms household trash (MSW) into a manufactured aggregate called MSWagg™, suitable for replacing virgin coarse aggregate in various construction applications. Today there are four methods to address MSW: source reduction, recycling, incineration, or landfill. The first two will continue to increase their contributions to the overall solution to MSW accumulation; however, MSW not addressed by those methods has historically not been cost-effective to utilize due to the organics and contamination present. According to IEA Bioenergy, landfilling produces approximately 154 pounds of methane per ton or a 100-yr global warming potential of 4312 pounds of CO₂/ton. Landfills range from 30-55% biodegradable and contribute 16% of global methane emissions annually. The MSWagg™ process will produce an estimated 56 lb of CO₂/ton of organic matter, divert useful plastics to efficient recycling. With optimization, LS's process could potentially become a carbon-neutral process.

Technical feasibility: Louis Structures' technical methodology removes all chemicals of concern and contaminants in MSW. Processing MSW into an aggregate that meets EPA and DOT standards is achieved by solubilization, suspension, dewatering, dilution, encapsulation, and sequestration. Stringent regulatory requirements are required to meet beneficial reuse acceptance of MSWagg in the construction industry. Louis Structures recently submitted an EPA contract application with UW-Oshkosh and Rohde Brothers /PAWL Group engineering (Plymouth, WI), which will further characterize MSWagg's process and product for uses in multiple industries.

LS has commercial potential in three areas: 1) Receiving MSW from disposal companies that would ordinarily dump the MSW in landfills. 2) Recovering recyclables from the MSW and selling them to commodities buyers. 3) Selling residual MSW converted to MSWagg™ to construction and road contractors as an environmentally friendly alternative to virgin aggregate.

The owners of the N3773 Garden Parkway property have kindly suggested their facility could be a site suitable to demonstrate our process at a pilot scale, potentially house a longer-term, processing program for some area municipal solid waste feeds during the weekdays. Picture #1 shows a green circled building which currently has large boilers and industrial tanks for water processing where material could be brought directly into the building via large windows on one end of the building. The outgoing product, once made into MSWagg could leave the building via conveyors loading dump trucks. A skid-loaded pretreatment system for water effluent from our

hydrothermal system is planned and a air quality compliant bag-house will be installed. The entire process will be conducted indoors and should pose no imposition to the usage of surrounding buildings or their visitors. The site is well-secluded and barred off to entry except those authorized to visit.

Please process our Chapter NR502 application. We are eager to get started with a pilot facility. We've been working up to this moment for over 5 years now. Please also see the included DNR recommendation (at the end of this document) we recently received delineating our potential pilot work with area landfills in need of drainage aggregate (up to 40,000 tons per year or more) in landfill cell construction that are newly beginning constructed in 2023 and beyond.

Regards,

Benjamin Louis Horvat



Save...

Print...

Clear Data

State of Wisconsin
Department of Natural Resources
Box 7921, Madison WI 53707-7921
dnr.wi.gov

Chapter NR 502 Non-Landfill Solid Waste Facility Initial Site Inspection (ISI) Application

Form 4400-209 (R 10/15)

Page # of ##

Notice: Under NR 502.04(2), Wis. Adm. Code, an owner or operator of facilities listed in Section II of this form is required to submit a request for an Initial Site Inspection (ISI) to the Department of Natural Resources before establishing or expanding a solid waste facility. This form contains information needed for an ISI request. Personal information collected will be used for administrative purposes and may be provided to requesters to the extent required by Wisconsin's Open Records Law [ss. 19.31-19.39, Wis. Stats.].

Instructions: The applicant should submit, at a minimum, the following to request an Initial Site Inspection:

1. A cover letter requesting the ISI along with a brief description of the proposed solid waste facility design and operation.
2. A completed copy of this form.
3. All pertinent attachments identified in Section V of this form

Send two copies of the application packet (cover letter, completed form and attachments) to the Solid Waste Program Supervisor at the DNR's Regional Office where your facility is located. Submit one electronic copy to the same address.

Section I – Facility Information

Applicant Last Name Horvat		First Name Benjamin	MI L	Title Founder / CEO
Phone Number (with area code) 262-721-7207	Mobile Phone (with area code) Same	Email Address benjamin@louisstructures.com		
Company/Municipality Name Louis Structures LLC		Facility Location (Street Address, Fire lane #) N3773 Garden Parkway, Sheboygan Falls, WI		
County Sheboygan	<input checked="" type="radio"/> City <input type="radio"/> Town <input type="radio"/> Village of	Legal Description of Property ____ ¼ of ____ ¼ of Section ____ , T ____ N, R ____ <input type="radio"/> E <input type="radio"/> W		

Present Land Use on the Property: (select all that apply)

- ☐ Agriculture ☒ Commercial ☐ Manufacturing ☐ Residential ☐ Other (specify): _____

Has the local government for facility been notified of your intentions for development of this Solid Waste facility? ☐ Yes ☐ No

Will the proposed facility design capacity be less than 100 tons per day? ☐ Yes ☐ No

Section II – Proposed Solid Waste Facility (select the appropriate facility)

Group A: ☐ Outside Storage, NR 502.05 ☐ Less than 50 tons/day Storage, NR 502.05(3)(k) ☐ Outside Processing, NR 502.08

Group B: ☐ Transfer, NR 502.07 ☐ Less than 50 ton/day Transfer, NR 502.07(2r)

Group C: ☐ Non-Exempt Compost NR 502.12

Group D: ☐ Less than 20,000 cy Yard Residuals Composting, NR 502.12(6) ☐ Less than 5,000 cy Source-Separated Compostable Material Composting, NR 502.12(7)

Group E: ☐ Incinerator, NR 502.09

Group F: ☐ Air Curtain Destructor, NR 502.10

Group G: ☐ Woodburning, NR 502.11

Group H: ☐ Municipal Solid Waste Combustor, NR 502.13

No Group: Solid Waste Facilities that cannot be located in a floodplain, but are not subject to other locational criteria. (Go to Section IV)

- ☒ Inside Storage, NR 502.05(4)(b) ☐ Inside Infectious Waste Storage, NR 526.09 ☒ Inside Processing, NR 502.08(3)(b)

Solid Waste Facilities that are not subject to specific locational criteria. (Go to Section IV)

- ☐ Non-Commercial Soil Borrow Site for the construction of a non-landfill solid waste facility, NR 502.04(2)(a)9

Click on the Y or N to select

Section III – Locational Criteria (Circle the appropriate responses corresponding to the facility Group above)

Will the proposed facility be located:		A	B	C	D	E	F	G	H
1. outside a designated floodplain?	1	Y / N	Y / N	Y / N	Y / N	Y / N	Y / N	Y / N	Y / N
2. at least 250 ft. from any private water supply wells?	2	Y / N	Y / N	Y / N	Y / N	Y / N	Y / N	Y / N	Y / N
3. at least 1,200 ft. from any public water supply wells?	3	Y / N	Y / N	Y / N	Y / N	Y / N	Y / N	Y / N	Y / N
4. at least 5 ft. from seasonal high groundwater table?	4	NA	NA	Y / N	Y / N	NA	NA	NA	NA
5. at least 250 ft. from navigable lakes, ponds or flowage?	5	Y / N	Y / N	NA	Y / N	NA	Y / N	Y / N	NA
6. at least 500 ft. from navigable lakes, ponds or flowage?	6	NA	NA	Y / N	NA	NA	NA	NA	NA
7. at least 250 ft. from navigable rivers and streams?	7	Y / N	Y / N	Y / N	Y / N	NA	Y / N	Y / N	NA
8. at least 100 ft., from property line? If no, describe Screening used:	8	NA	Y / N	NA	Y / N	NA	Y / N	Y / N	NA
9. at least 250 ft., from property line? If no, describe Screening used:	9	Y / N	NA	Y / N	NA	NA	NA	NA	NA
10. at least ¼ mile from any resident who has not provided written consent to the DNR?	10	NA	NA	NA	NA	NA	Y / N	Y / N	NA
11. at least 1,000 ft. from highway or parks without screening? If no, describe Screening used:	11	Y / N	Y / N	Y / N	Y / N	Y / N	Y / N	Y / N	NA
12. outside the limits of fill of an existing or abandoned landfill?	12	NA	NA	NA	NA	NA	NA	Y / N	NA
13. Will putrescible waste be accepted? If Yes, will the facility be:	13	Y / N	Y / N	Y / N	Y / N	Y / N	NA	NA	Y / N
14. at least 10,000 ft. from any turbojet airport runways?	14	Y / N	Y / N	Y / N	Y / N	Y / N	NA	NA	Y / N
15. at least 5,000 ft. from any piston airport runways?	15	Y / N	Y / N	Y / N	Y / N	Y / N	NA	NA	Y / N

Section III – Locational Criteria (Circle the appropriate responses corresponding to the facility Group above)

16. operated in a manner to not create a substantial bird hazard?	16	Y / N	Y / N	Y / N	Y / N	Y / N	NA	NA	Y / N
---	----	-------	-------	-------	-------	-------	----	----	-------

Section IV – Performance Standards (ss. NR 502 04(1) and (2)(b)6 Wis. Adm. Code) Select the appropriate response.**Will the proposed solid waste activity cause:**

- | | |
|---|--|
| 1. a detrimental effect on any surface water? | Y / <input checked="" type="radio"/> N |
| 2. an impact on any wetlands? (If the facility will impact a wetland, ch. NR 103 applies.) | Y / <input checked="" type="radio"/> N |
| 3. a detrimental effect on groundwater quality? | Y / <input checked="" type="radio"/> N |
| 4. a detrimental impact on groundwater quality or a ch. NR 140 groundwater quality standard to be exceeded? | Y / <input checked="" type="radio"/> N |
| 5. a significant adverse impact on critical habitat areas? | Y / <input checked="" type="radio"/> N |
| 6. concentration of explosive gases which exceed 25% of the lower explosive limit for such gases in structures, soils or air beyond the facility property boundary? | Y / <input checked="" type="radio"/> N |

Section V – Attachments (s. NR 502 04(2) Wis. Adm. Code)

The following supporting documents are provided with this Initial Site Inspection request:

1. A regional map or aerial image with 1" = 500' minimum scale showing existing land use activities with the image scale and north arrow identified. This document should have markings outlining a ¼ mile radius around the proposed facility. The proposed facility property boundary, surface waters, floodplains, public parks, roadways, water supply wells and residences within that radius should be labeled.

A site plan that shows the layout of the proposed site would also be helpful. A suggested scale would be 1" = 100' maximum. This document would have markings outlining the limits of the proposed activity on the property and could be used to show storm water drainage patterns and control structures within the property.

2. Documentation that you believe supports and justifies the Department issuing an exemption for any "no" response in Section III above or "yes" in Section IV (select the appropriate box):

- a. ☒ Not Applicable ☐ Yes: Section III Locational Criteria (questions #1-15) exemption request(s) attached
- b. ☒ Not Applicable ☐ Yes: Section IV Performance Standards (questions #1-6) exemption request(s) attached

Section VI – Applicant Certification

I certify that, to the best of my knowledge, the information provided herein is accurate and was prepared in compliance with all applicable requirements in ch. NR 502, Wis. Adm. Code:

Authorized Representative (Print) Benjamin Louis Horvat	Title Founder / CEO	Telephone Number 262-721-7207
Applicant Mailing Address 1505 S.12th Street	City Sheboygan	State ZIP Code WI 53081
Signature <i>Benjamin Horvat</i>	Date Signed 8-29-22	Email Address benjamin@LouisStructures.com

For Department Use Only

Assigned Staff Name	Date Received	Response Date	Assigned FID #
<hr/> Date <input type="radio"/> Yes <input type="radio"/> No WDNR Bureau of Endangered Resources <i>Natural Heritage Inventory</i> identified no critical habitat areas or State or local natural areas on the proposed facility?			
<hr/> Date <input type="radio"/> Yes <input type="radio"/> No WDNR Bureau of Facilities and Lands <i>Historical and Archaeological Site Maps</i> identified no historical, scientific, or archeological areas on the proposed facility?			
<hr/> ISI Date <input type="checkbox"/> Non-complex facility with office review of submittals and databases only			

Preliminary Opinion based upon department review of submitted information:

- ☐ The facility, as proposed, appears to meet all the applicable performance and location standards.
- ☐ The facility, as proposed, has some conflicts with performance and location standards. Sufficient information has been provided to demonstrate, circumstances which warrant exemptions from those standards.
- ☐ The facility, as proposed, does not appear to meet applicable performance and location standards. Insufficient information has been provided issue exemptions from those standards. If the project is pursued, the applicant will need to address these issues.

Plan of Operation Status for this facility:

- ☐ The facility type identified in Section II does not require department approval of a Plan of Operation Report.
- ☐ A Plan of Operation has been submitted and reviewed. A Plan of Operation Approval is part of the ISI response.
- ☐ A submitted Plan of Operation Report has not provided adequate information for the department to issue a decision at this time. Additional information will need to be submitted prior to the Department issuing a determination.
- ☐ A Plan of Operation Report has not been submitted. To pursue this proposal a plan of operation must be submitted as specified in applicable sections of ch. NR 502, Wis. Adm. Code.

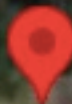

N3773 Garden
Pkwy, Sheboygan Falls...

TRUCK
ENTRY

Sheboygan Falls Asylum



TRUCK
EXIT

VN

VN

© 2022 Google

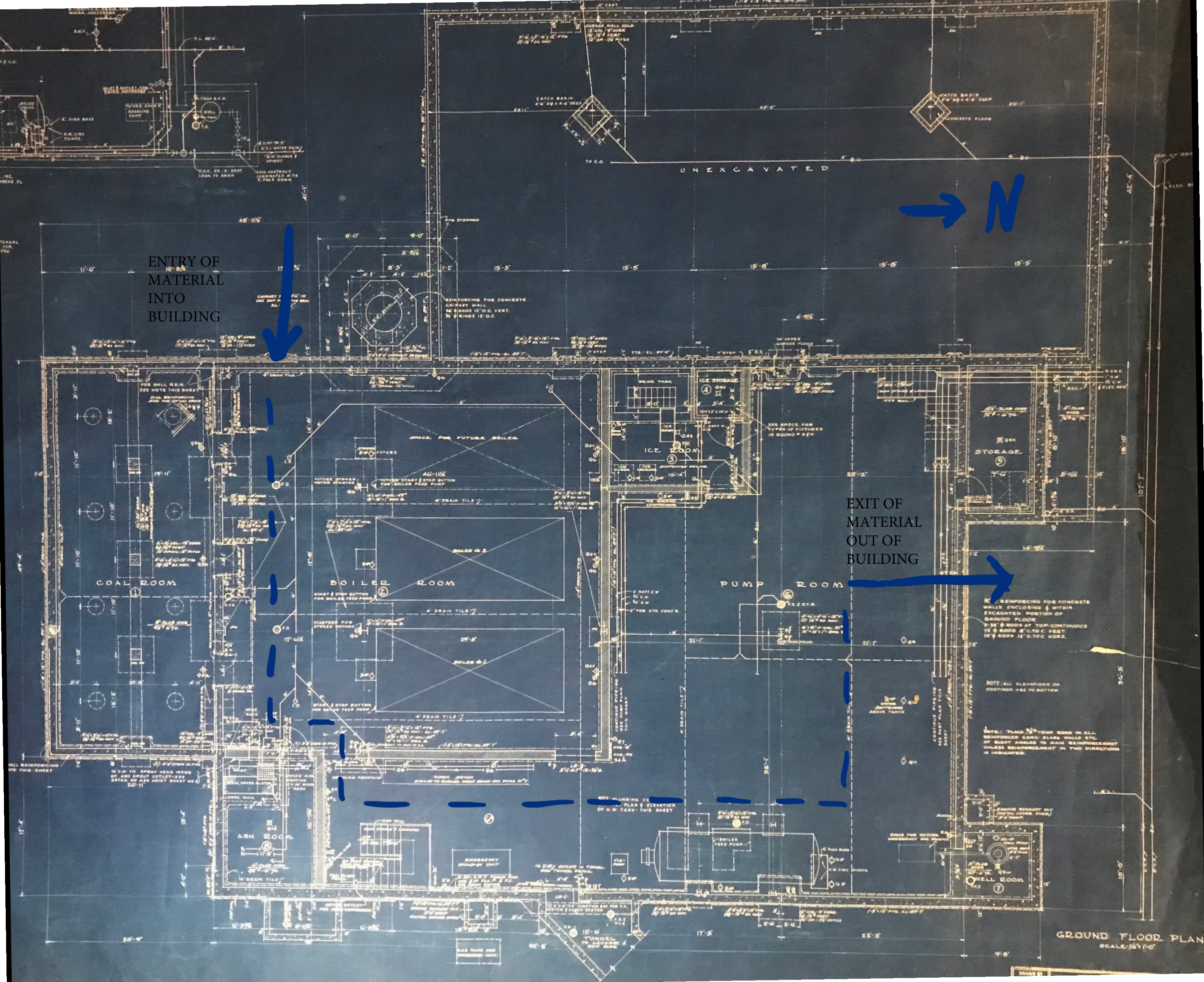

ENTRY OF
MATERIAL
INTO
BUILDING

EXIT OF
MATERIAL
OUT OF
BUILDING

GROUND FLOOR PLAN
SCALE 1/4" = 1'-0"

St Thomas
Lutheran Church



VN

N

I



N3773 Garden
Pkwy, Sheboygan Falls...

Custom Care &
Transport Services



Kim's 5 Corners Tavern



Steven Tenpas Dryw...

V

V

V

I

M